

# GRAB BARS

3782, 3784, 3786 / 3792, 3794, 3796 / 3802, 3804, 3806 / 3812, 3814, 3816

Wall mounted  
2 year warranty

The essential aspect is primarily that the grab bars are a sturdy and comfortable aid. The grab bars should contribute to a safe and secure experience, assisting users when using public or commercial toilet facilities. Additionally, it is important that the grab bars have an aesthetic appeal, seamlessly blending into the restroom environment without drawing attention.



## Technical data

Prod. No	L1	L2	D	H	Weight
3782	458 mm	238 mm	98 mm	Ø32 mm	1,43 kg
3784	18"	9.37"	3.86"	Ø1.26"	3.16 lb
3786					
3792	610 mm	390 mm	98 mm	Ø32 mm	1,67 kg
3794	24"	15.35"	3.86"	Ø1.26"	3.67 lb
3796					
3802	915 mm	695 mm	98 mm	Ø32 mm	2,13 kg
3804	36"	27.36"	3.86"	Ø1.26"	4.68 lb
3806					
3812	1067 mm	847 mm	98 mm	Ø32 mm	2,35 kg
3814	42"	33.35"	3.86"	Ø1.26"	5.19 lb
3816					

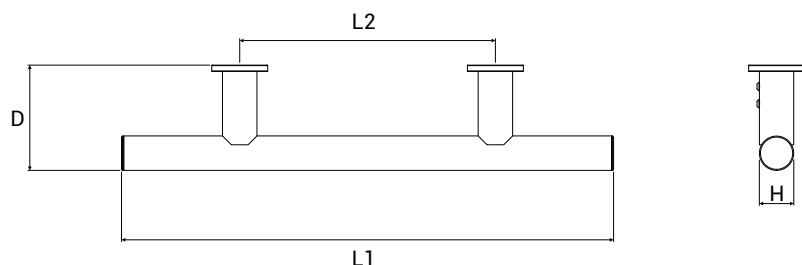

## Application

Grab bars in public and commercial toilets are primarily designed to improve safety and accessibility for individuals with limited mobility or elderly individuals.

The grab bars can be combined with all DAN DRYER product lines; BJÖRK, LOKI, TAPS, and Stainless Design.

## Installation

Wall mounted

## Tender text

Sturdy and comfortable aid. Powder coated stainless steel.  
Net weight: 1,43 - 2,35 kg / 3.16 - 5.19 lb

## Standard colors

RAL 9003, white gloss 60  
RAL 9005 matte black, gloss 10  
RAL Classic colors

## References

Offices and administration, shopping malls, restaurants, hotels, airports and public swimming pools, schools, public institutions and cultural centres.